

26 Lillee Crescent, Tullamarine Vic 3043, Australia - Telephone: +61 (0)3 9310 5566 - Fax: +61 (0)3 9310 5577
 Email: sales@airportmetals.com.au

STOCK AVAILABLE EX MELBOURNE WAREHOUSE AS AT 1st SEPTEMBER 2010
FOR CURRENT PRICING CONTACT AIRPORT METALS SALES DEPARTMENT ON ABOVE NUMBERS

ALUMINIUM SQUARE BAR

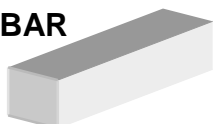

Type - Temper	Dimensions Inches
2024-T351	0.500 SQ
2024-T351	0.750 SQ
2024-T351	1.000 SQ
2024-T351	1.250 SQ
6061-T651	0.500 SQ
6061-T651	1.000 SQ
6061-T651	1.500 SQ
7075-T6511	1.000 SQ

ALUMINIUM RECTANGULAR BAR

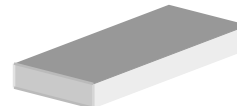

Type - Temper	Dimensions Inches
2024-T351	0.500 X 2.00
2024-T351	0.750 X 6.00
2024-T351	1.000 X 2.00
2024-T351	1.250 X 3.00
2024-T4	0.375 X 1.00
6061-T6511	0.250 x 1.00
6061-T6511	0.250 X 1.50
6061-T6511	0.250 X 2.00
7075-T651	0.750 X 3.00
7075-T6511	1.000 X 2.50
7075-T651	2.000 X 2.50
7075-T7351	2.000 X 2.50

CHROME MOLY RECTANGULAR BAR

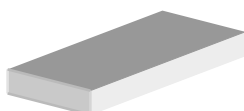

Specification	Dimensions Inches
4130N MIL-S-6758	0.500 X 1.000
4130D4 MIL-S-6758	1.000 X 2.000
4130D4 MIL-S-6758	1.500 X 1.500

ALLOY STEEL HEX BAR



Specification	Dimensions Inches
BSS80D Cres Bright	0.625 AF

ALUMINIUM HEX BAR

Type - Temper	Dimensions Inches
2024-T351	1.125 AF
2024-T351	1.250 AF

26 Lillie Crescent, Tullamarine Vic 3043, Australia - Telephone: +61 (0)3 9310 5566 - Fax: +61 (0)3 9310 5577
 Email: sales@airportmetals.com.au

STOCK AVAILABLE EX MELBOURNE WAREHOUSE AS AT 1st SEPTEMBER 2010
 FOR CURRENT PRICING CONTACT AIRPORT METALS SALES DEPARTMENT ON ABOVE NUMBERS

ALUMINIUM EXTRUSIONS

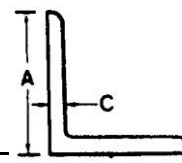

Part Number	Material	Shape	on Inches		
			A	B	C
AND10133-0401-2	2024-T3511	90° angle	0.50	0.50	0.063
BAC1503-1470-6	6061-T6511	90° angle	0.75	0.75	0.062
AND10133-0601-2	2024-T3511	90° angle	0.75	0.75	0.063
AND10133-0601-7	7075-T6511	90° angle	0.75	0.75	0.063
AND10133-0602-6	6061-T6511	90° angle	0.75	0.75	0.094
AND10133-0603-6	6061-T6511	90° angle	0.75	0.75	0.125
AND10134-1001-7	7075-T6511	90° angle	1.00	0.625	0.062
TMS60-138-2	2024-T3511	90° angle	1.00	0.75	0.063
BAC1503-100046-7	7075-T6511	90° angle	1.00	1.00	0.050
TMS60-5126-2	2024-T3511	90° angle	1.00	1.00	0.050
AND10133-1001-2	2024-T3511	90° angle	1.00	1.00	0.063
AND10133-1001-7	7075-T6511	90° angle	1.00	1.00	0.063
BAC1503-2731-7	7075-T6511	90° angle	1.00	1.00	0.063
AND10133-1002-2	2024-T3511	90° angle	1.00	1.00	0.094
AND10133-1003-2	2024-T3511	90° angle	1.00	1.00	0.125
AND10133-1003-6	6061-T6511	90° angle	1.00	1.00	0.125
AND10134-1204-7	7075-T6511	90° angle	1.00	1.25	0.063
BAC1503-2773 / LS3237/TMS60-1757	2024-T3511	90° angle	1.00	1.25	0.125
BAC1503-2811-2	2024-T3511	90° angle	1.00	1.50	0.062
AND10134-1404-6	6061-T6511	90° angle	1.00	1.50	0.125
AND10134-1404-7	7075-T6511	90° angle	1.00	1.50	0.125
AND10133-1201-2	2024-T3511	90° angle	1.25	1.25	0.062
11411418A63 (ASTM-B-221)	6063-T52	90° angle	1.25	1.25	0.125
AND10133-1203-2	2024-T3511	90° angle	1.25	1.25	0.125
AND10133-1203-6	6061-T6511	90° angle	1.25	1.25	0.125
AND10133-1401-7	7075-T6511	90° angle	1.50	1.50	0.063
BAC1503-5818-7	7075-T6511	90° angle	1.50	1.50	0.094
AND10133-1403-2	2024-T3511	90° angle	1.50	1.50	0.125
AND10133-1403-6	6061-T6511	90° angle	1.50	1.50	0.125
AND10133-1403-7	7075-T6511	90° angle	1.50	1.50	0.125
BAC1514-1365/TMS60-6566	2024-0	90° angle	1.88		0.066
				1.78	0.125
AND10133-2001-2	2024-T3511	90° angle	2.00	2.00	0.092
AND10133-2002-6	6061-T6511	90° angle	2.00	2.00	0.125
AND10133-2003-6	6061-T6511	90° angle	2.00	2.00	0.188
2314A63 (ASTM-B-221)	6063-T52	90° angle	2.00	3.00	0.250
LS5108/TMS60-26225	7075-T6511	190°55' angle	1.05	1.05	0.125
AND10136-2404-7	7075-T6511	T	1.625	2.50	0.094
BAC1505-101100-7	7075-T6511	T	3.00	2.50	0.080
BAC1505-100678-2	2024-T3511	T	4.25	3.00	0.130
60-8149-2	2024-T3511	C Channel	0.50	1.00	0.051
CV553 (Pimalco 231001-1-2)	7075-T73511	Seat Track			