

**CHROME MOLY ROUND TUBE**  
**AMS 6360 (AMS-T-6736) Type 4130N**



Outside Diameter	Wall thickness in Inches and Millimetres												
	Inches Millimetres	0.028 0.71	0.035 0.89	0.049 1.24	0.058 1.47	0.065 1.65	0.083 2.10	0.095 2.41	0.120 3.05	0.125 3.18	0.156 3.96	0.188 4.76	0.250 6.35
1/4 - 0.250 6.35	N/A				N/A	N/A	N/A	N/A	N/A	N/A	N/A	N/A	N/A
5/16 - 0.3125 7.94	N/A					N/A	N/A	N/A	N/A	N/A	N/A	N/A	N/A
3/8 - 0.375 9.53	N/A						N/A	N/A	N/A	N/A	N/A	N/A	N/A
7/16 - 0.4375 11.11	N/A	N/A	N/A				N/A	N/A	N/A	N/A	N/A	N/A	N/A
1/2 - 0.5 12.70	N/A						N/A		N/A	N/A	N/A	N/A	N/A
5/8 - 0.625 15.88							N/A		N/A	N/A	N/A	N/A	N/A
3/4 - 0.75 19.05	N/A								N/A		N/A	N/A	N/A
7/8 - 0.875 22.21	N/A								N/A		N/A	N/A	N/A
1 - 1.0 25.40	N/A								N/A				
1 1/8 - 1.125 28.58	N/A							N/A	N/A	N/A	N/A	N/A	N/A
1 1/4 - 1.25 31.75	N/A								N/A	N/A	N/A		
1 3/8 - 1.375 34.93	N/A								N/A				N/A
1 1/2 - 1.5 38.10	N/A								N/A		N/A		
1 5/8 - 1.625 41.28	N/A	N/A						N/A	N/A	N/A			N/A
1 3/4 - 1.75 44.45	N/A				N/A				N/A				N/A
2 - 2.0 50.80	N/A	N/A							N/A	N/A			
2 1/4 - 2.25 57.15	N/A	N/A	N/A	N/A	N/A	N/A			N/A		N/A		
2 1/2 - 2.5 63.50	N/A	N/A	N/A	N/A	N/A	N/A			N/A	N/A			
2 3/4 - 2.75 69.85	N/A	N/A	N/A	N/A	N/A	N/A	N/A	N/A		N/A	N/A	N/A	N/A
3 - 3.0 76.20	N/A	N/A	N/A	N/A	N/A	N/A			N/A	N/A	N/A	N/A	
3 1/4 - 3.250 82.55	N/A	N/A	N/A	N/A	N/A	N/A	N/A	N/A	N/A	N/A	N/A	N/A	
3 1/2 - 3.500 88.90	N/A	N/A	N/A	N/A	N/A	N/A	N/A	N/A	N/A	N/A	N/A	N/A	

## CHROME MOLY SQUARE & RECTANGULAR TUBE



Outside A x Inches B	WT Inches C
0.500 x 0.500	0.035
0.625 x 0.625	0.065
0.750 x 0.750	0.035
0.750 x 0.750	0.065
0.875 x 0.875	0.065
1.000 x 1.000	0.035
1.000 x 1.000	0.049
1.000 x 1.000	0.065
1.000 x 1.500	0.065
1.500 x 1.500	0.065

## CHROME MOLY ROD



Condition	Specification	Dimensions Inches
4130 D4	MIL-S-6758	0.188
4130 D4	MIL-S-6758	0.250
4130 D4	MIL-S-6758	0.3125
4130 D4	MIL-S-6758	0.375
4130 D4	MIL-S-6758	0.500
4130 F4	MIL-S-6758	0.500
4130 F4	MIL-S-6758	0.625
4130 D4	MIL-S-6758	0.750
4130 F4	MIL-S-6758	0.750
4130 F4	MIL-S-6758	1.000
4130 F4	MIL-S-6758	1.250
4130 F4	MIL-S-6758	1.500
4130 F4	MIL-S-6758	2.000
4130 D4	MIL-S-6758	1.000
4130 D4	MIL-S-6758	1.250
4130 D4	MIL-S-6758	1.500
4130 D4	MIL-S-6758	2.000
4130 D4	MIL-S-6758	2.250
4130 D4	MIL-S-6758	2.500
4130 F4	MIL-S-6758	2.500
4130 D4	MIL-S-6758	2.750
4130 D4	MIL-S-6758	3.000
4130 D4	MIL-S-6758	4.000

## CHROME MOLY RECTANGULAR BAR

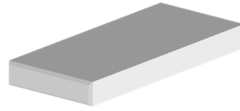

Specification	Dimensions Inches
4130D4 MIL-S-6758	0.500 x 1.250
4130D4 MIL-S-6758	1.000 x 2.000
4130D4 MIL-S-6758	1.500 x 1.500

## CHROME MOLY SHEET

Type	Thickness	Sheet Size
4130 Normalised Sheet – AMS 6345	0.025"	6ft x 3ft
4130 Normalised Sheet – AMS 6345	0.032"	6ft x 3ft
4130 Normalised Sheet – AMS 6345	0.040"	6ft x 3ft
4130 Normalised Sheet – AMS 6345	0.050"	6ft x 3ft
4130 Normalised Sheet – AMS 6345	0.063"	6ft x 3ft
4130 Normalised Sheet – AMS 6345	0.071"	6ft x 3ft
4130 Normalised Sheet – AMS 6345	0.080"	6ft x 3ft
4130 Normalised Sheet – AMS 6345	0.080"	12ft x 3ft
4130 Normalised Sheet – AMS 6345	0.090"	6ft x 3ft
4130 Normalised Sheet – AMS 6345	0.100"	6ft x 3ft
4130 Normalised Sheet – AMS 6345	0.125"	6ft x 3ft
4130 Normalised Sheet – AMS 6345	0.160"	6ft x 3ft
4130 Normalised Sheet – AMS 6345	0.190"	6ft x 3ft
4130 Normalised Sheet – AMS 6345	0.250"	6ft x 3ft
4130 Annealed Sheet – AMS 6350	0.050"	6ft x 3ft
4130 Annealed Sheet – AMS 6350	0.063"	6ft x 3ft